

ESTIMATED QUANTITIES
 BRIDGE DECK PARTIAL = 30 SY
 APPROACH PVT. = 15 SY

STATE OF TENNESSEE DEPARTMENT OF TRANSPORTATION OFFICE OF BRIDGE INSPECTION AND PEPAIR	BRIDGE NO. 19-1440-.36 R BRIDGE FED ID : 19104400001 CROSSING: CHARLOTTE AVE.	COUNTY: DAVIDSON SCALE : 1:10 SKEW : 78° R	BRIDGE LENGTH : 200' BRIDGE WIDTH : 52.5' DATE : 06-30-2017 DRAWN ASHRAF ARMANIOS	P*① OF ②
---	---	--	--	----------

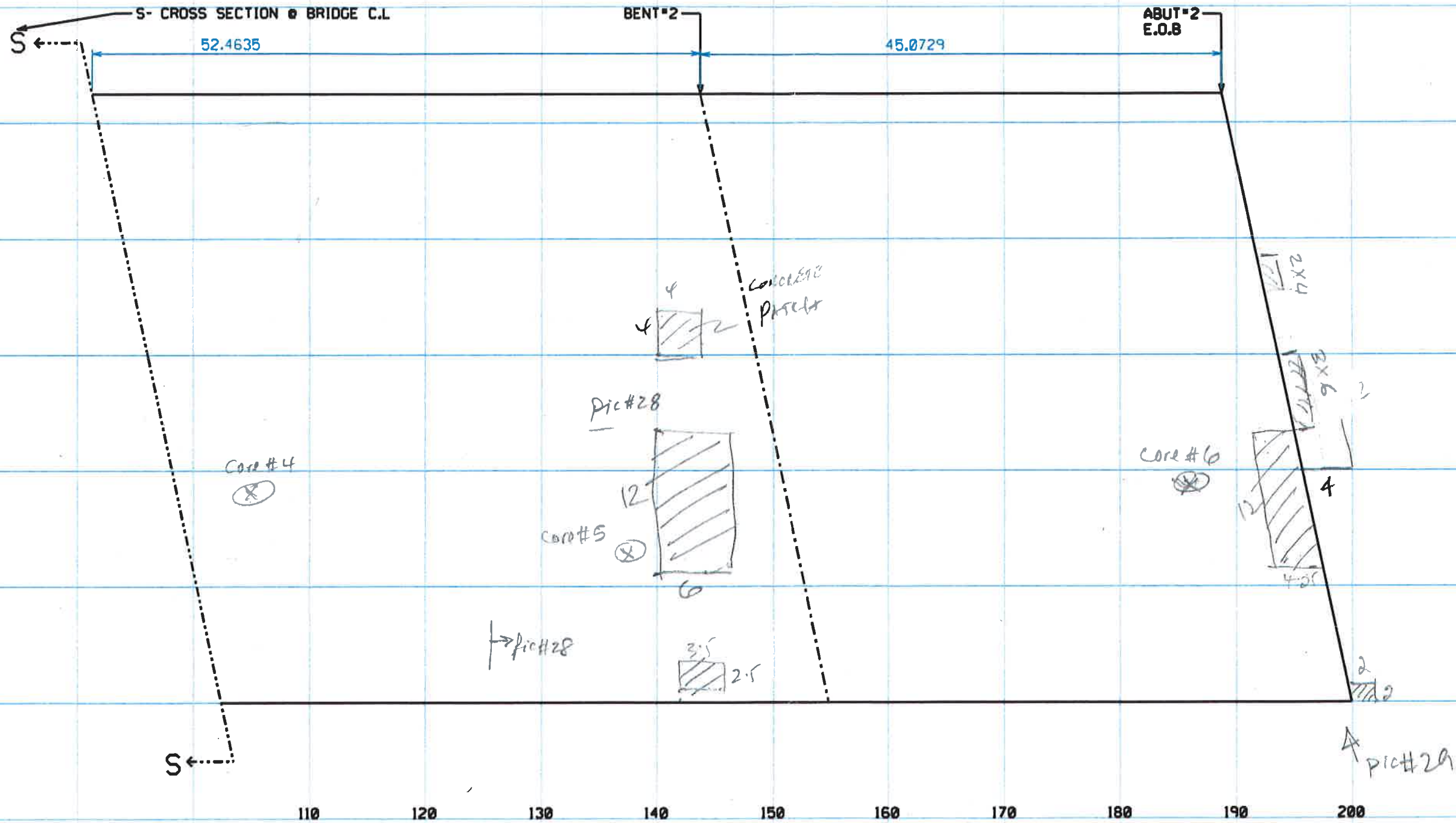

STATE OF TENNESSE DEPARTMENT OF TRANSPORTATION OFFICE OF BRIDGE INSPECTION AND PEPAIR	BRIDGE NO. 19-1440-.36 R	COUNTY: DAVIDSON	BRIDGE LENGTH : 200'	P# (2) OF (2)
	BRIDGE FED ID : 19104400001	SCALE : 1:10	BRIDGE WIDTH : 52.5'	
	CROSSING: CHLOTTE AVE.	SKEW : 78° R	DATE : 06-30-2017	
			DRAWN ASHRAF ARMANIOS	

Photographs

Bridge ID#: 19104400001

Date: 02/22/2016



BRIDGE PARAPET "B" END RT. MISALIGNED



BRIDGE PARAPET "B" END LT. IMPACT DAMAGE

LEFT @ ABUT #2

PRODUCED PURSUANT TO
PUBLIC RECORDS REQUEST
This document is covered by 23 USC §409
And its production pursuant to a public
document records request does not
waive the provisions of §409



Pic #27, Partial On Right Shoulder



Pic #28, Partial, Asphalt Patches; Bridge No. 19-I440-0.36R



Pic # 29 Patches along Joint 2 @ Abut. #2



Pic. #1 Underside View; Bridge No. 19-I440-0.36R